



TILES & PAVERS

SONOMA CAST STONE CORPORATION
Makers of NuCrete™, The World's Only Stainless Concrete
877.283.1897 • www.sonomastone.com



For more product info, or to download replacement forms, see: www.sonomastone.com

Tile • FlameStone



24"

16"



2"

16 X 24



24"

24"

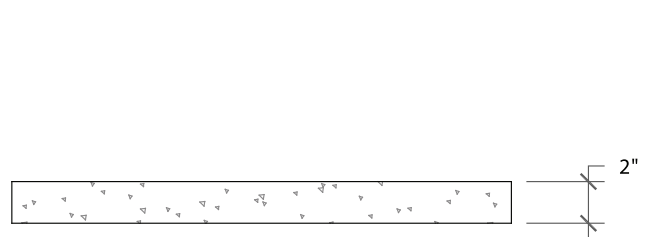

2"

24 X 24

Designs ©2007 Sonoma Cast Stone Corp. All rights reserved.

Visit www.sonomastone.com to see photos of this and other products.

• DESCRIPTION

Pre-cast concrete tile simulating flamed granite texture. Perfect as an exterior paver or in a rustic kitchen.

Refer to Tile Accessory page for pieces that compliment these tiles (p25).

• FACTS

Tiles come in Classic Concrete in a mold release finish. As the term implies, tiles are "as is" when released from their molds.

Tiles are not diamond-sanded, sealed and waxed.

Tiles are currently not available Stainless Nucrete™.

24 standard colors. See: www.sonomastone.com, catalog or techbinder. Custom colors available. Order samples online, or call 877-283-2400 x113.

Tiles are unfinished and unsealed. Sealing by installer.

Thin-set mortar can be used to install tiles to solid, level substrate.