

B: 5 1/2" MIN. FOR DECK-MOUNT FAUCET.  
2" MIN. FOR WALL-MOUNT FAUCET.

A: 2" MIN., 3 1/2+ IF SINK IS TO FIT INTO CABINET

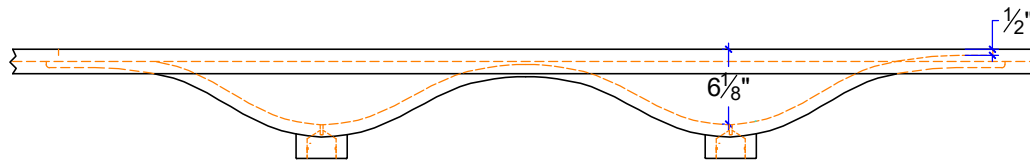

**FRONT ELEVATION, STD. EDGE**

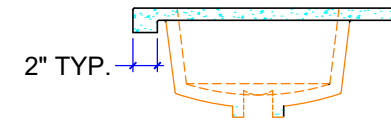
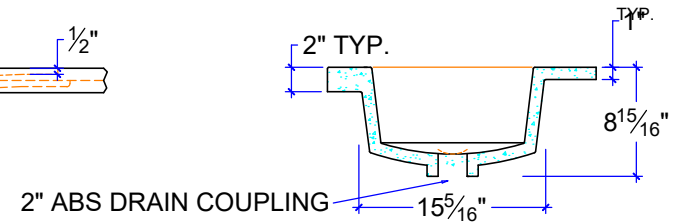

**SECTION @ DRAIN**

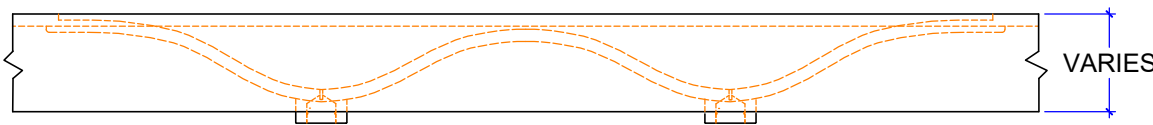

**FRONT ELEVATION, EXTENDED FRONT APRON**

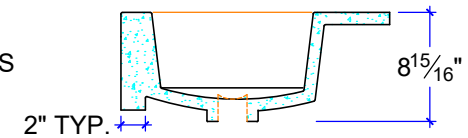

**SECTION @ DRAIN**



**RESIDENTIAL DOUBLE WAVESINK**  
CUSTOM SIZE COUNTERTOP WITH FIXED SIZE BASIN  
DIMENSIONS ARE INSIDE SINK

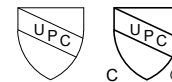

IAPMO Certificate of Listing #4816



(877)283-2400  
www.sonomastone.com  
sales@sonomastone.com  
All rights reserved