

WV-COM-3

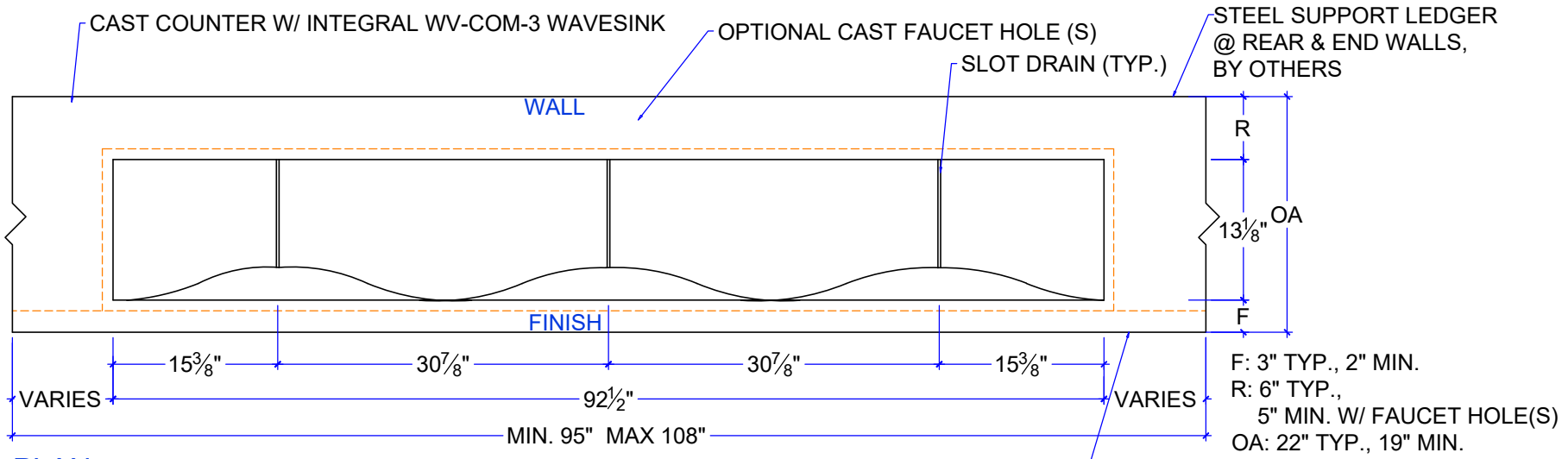

PLAN

INTEGRAL SIDE EXTENSION-SPECIFY WALL / FINISHED END

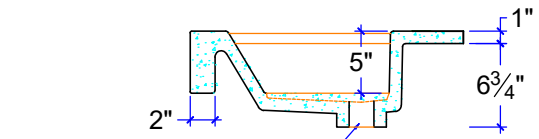
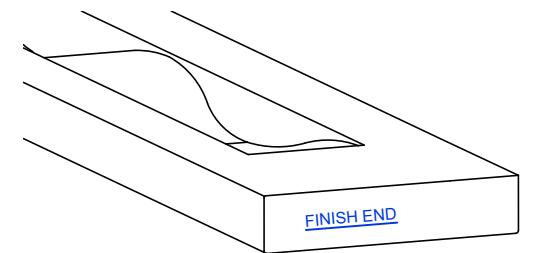
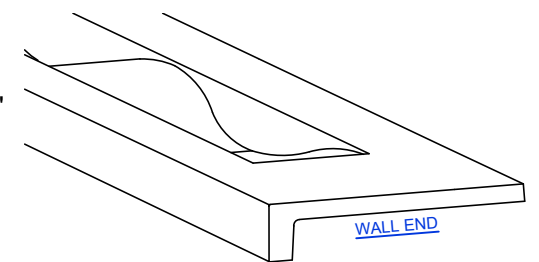
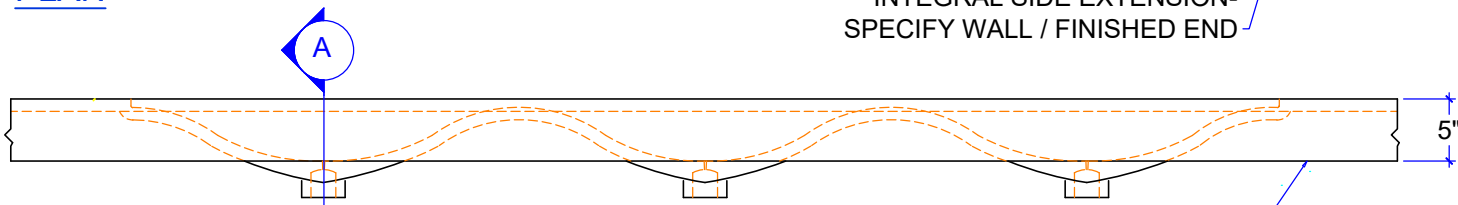

SECTION A

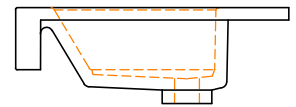

WALL END

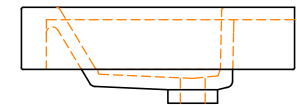

FINISH END



COMMERCIAL TRIPLE WAVESINK
 CUSTOM SIZE COUNTERTOP WITH FIXED SIZE BASIN
 DIMENSIONS ARE INSIDE SINK

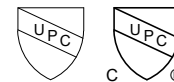

IAPMO Certificate of Listing #4816



(877)283-2400
 www.sonomastone.com
 sales@sonomastone.com
 All rights reserved